

CBB Chucks

Ball-Bearing Drill Chuck with Key for Production Drilling Equipment

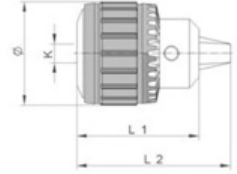

- Drill chuck with key for industrial applications that require the toughest machining conditions.
- Equipped with ball bearings to reduce friction in the tightening mechanism and provide a better grip on the drill shaft.
- The jaws, gear ring and body are all totally hardened to avoid wear and extend the life of the drill chuck.
- The one-piece gear ring and sleeve eliminate the possibility of tooth breakage.
- Fits tools from 1/32" through 1".
- Machine fitting via standard Jacobs® tapers.



EDP Number	Part Number	Capacity Inch	Mount K	Key Model	Dimensions (Inch)			List Price
					Ø	L1	L2	
L40070B	CBB-08 J2	1/32 - 5/16	2JT	K30	1.451	1.933	2.369	\$117.83
L40071B	CBB-10 J2	1/32 - 3/8	2JT	K32	1.790	2.072	2.670	\$125.84
L40072B	CBB-13 J3	1/32 - 1/2	3JT	K3	2.441	2.953	3.701	\$183.07
L40626B	CBB-13 J6	1/32 - 1/2	6JT	K3	2.441	2.953	3.701	\$183.07
L40073B	CBB-16 J3	1/32 - 5/8	3JT	K4	2.638	3.189	4.016	\$205.96
L40074B	CBB-19 J4	1/8 - 3/4	4JT	K4	2.953	3.898	4.921	\$308.96
L40075B	CBB-25 J5	13/64 - 1	5JT	K5	3.661	4.409	5.787	\$423.41



CY Chucks

Plain Bearing Drill Chuck with Key for Stationary Machines

- Specially designed for stationary drilling, turning, milling and wood working machines.
- The one-piece gear ring and sleeve eliminates the possibility of tooth breakage.
- The jaws, gear ring and body are all totally hardened to avoid wear and lengthen the life of the drill chuck.
- Fits tools up to 3/4" in diameter.
- Chucks come standard with Jacobs® taper mounts.

KD¹ = EQUIPPED WITH POSITIVE DRIVE SLOT
PD² = EQUIPPED WITH PIN TYPE POSITIVE DRIVE
C³ = EQUIPPED WITH LOCKING COLLAR

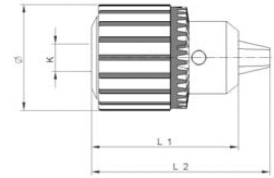

Heavy Duty Plain Bearing

EDP Number	Part Number	Capacity Inch	Mount K	Key Model	Dimensions (Inch)			List Price
					Ø	L1	L2	
L40131B	CY-10 J-2 SP	1/32 - 3/8	2JT	K34	1.693	2.165	2.677	\$84.21
L40116B	CYX-13 J-2	1/32 - 1/2	2JT	K3	2.087	2.717	3.504	\$86.46
L40117B	CYX-13 J-6	1/32 - 1/2	6JT	K3	2.087	2.717	3.504	\$112.30
L40118B	CYX-13 J-33	1/32 - 1/2	33JT	K3	2.087	2.717	3.504	\$89.83

Medium Duty Plain Bearing

EDP Number	Part Number	Capacity Inch	Mount K	Key Model	Dimensions (Inch)			List Price
					Ø	L1	L2	
L40129B	CY-04 J-0	1/32 - 5/32	0JT	K0	0.866	1.142	1.417	\$72.98
L40130B	CY-06 J-1	1/32 - 1/4	1JT	CK4	1.260	1.575	1.929	\$61.74
L40132B	CY-10 J-1	1/32 - 3/8	1JT	K34	1.457	2.008	2.362	\$93.20
L40133B	CY-10 J-2	1/32 - 3/8	2JT	K34	1.457	2.008	2.362	\$97.69
L40134B	CY-13 J-33	1/32 - 1/2	33JT	K2	1.811	2.441	3.031	\$95.45
L40136B	CY-13 J-33 KD ¹	1/32 - 1/2	33JT	K2	1.811	2.795	3.386	\$66.00
L40119B	CYX-13 J-33C ³	1/32 - 1/2	33JT	K3	2.087	3.386	4.173	\$65.05
L40528B	CY-13 J-6	1/32 - 1/2	6JT	K2	1.811	2.440	3.031	\$95.45
L40531B	CY-16 J-33	1/32 - 5/8	33JT	K3	2.244	3.031	3.740	\$134.77
L40532B	CY-16 J-6	1/32 - 5/8	6JT	K3	2.244	3.031	3.740	\$134.77
L40113B	CY-16 J-3	1/32 - 5/8	3JT	K3	2.168	3.069	3.740	\$134.77
L40114B	CY-16 J-3 KD ¹	1/32 - 5/8	3JT	K3	2.244	3.346	4.016	\$103.00
L40115B	CY-16 J-3 PD ²	1/32 - 5/8	3JT	K3	2.244	3.346	4.016	\$120.00
L40120B	CY-19 J-3	13/64 - 3/4	3JT	K4	2.559	3.346	4.331	\$168.47
L40121B	CY-19 J-3 KD ¹	13/64 - 3/4	3JT	K4	2.559	3.504	4.567	\$117.00
L40122B	CY-19 J-3 PD ²	13/64 - 3/4	3JT	K4	2.559	3.504	4.567	\$117.00